



newECO. The simple movable wall solution.



At a glance

- Components: standard, door and telescopic components
- Dimensions: component thickness: 100 mm
component width: max. 1280 mm
- Pressure bar: top and bottom – extendible black lacquered aluminium pressure bars with double sealing mouldings
- Operation: manual operation of components; component fixed using crank handle supplied
- Component connection: aluminium-dipped mouldings E6/EV 1, naturally anodised aluminium
- UM type: upright component edges protected by aluminium perimeter moulding
- KA type: upright component edges to match surface, no visible moulding when closed
- Sound insulation as per DIN EN 10140-2:
up to Rw, P 53 dB, standard version Rw, P 39 dB
- Planking: plastic-coated chipboard 16 mm E1/P2
as per DIN EN 14322
- Surface: melamine resin surfaces, HPL surfaces, real wood veneers, lacquered surfaces

Simply convincing: the Nüsing newECO 100 wall

Your reliable partner

Reliable and trusting cooperation with our customers is the basis for our success. Our individual solutions and our consulting service, as well as assistance in the preparation of technical specifications and working drawings, make us a capable partner. Our sales team is your partner – from planning and measurement through to installation. The continuous training of our staff ensures the quick processing of customised, detailed solutions.

The movable partition-wall system

Sometimes, less is more: not every space requires a partition wall solution with unlimited design options and trim levels. Quality, functionality and handling have to be of high quality in any case – a requirement met by the Nüsing NEWeco 100 uncompromisingly.

Quality at an affordable price.

Comfortable, fast and easy to use – the Nüsing NEWeco 100 offers tried and tested Nüsing-brand quality:

- Aluminium mouldings with integrated seals for connection element
- Design: frameless lightweight design with height adjustment
- Contact pressure 1.500 N.
- Recessed PVC handles in the doors

See for yourself – the Nüsing NEWeco 100 is our economical solution for your professional partition wall requirements.



"Parking" area for Z8 L. Folding away the individual components is optimally adapted to the relevant space.

Partition-wall technology and sound insulation, manual operation

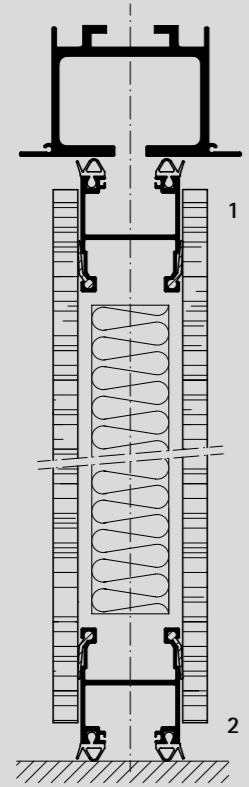

1+2| Pressure bars at the top and bottom of wall components ensure enormous stability and the necessary sound insulation.

„Parking“ the wall components

1–10| How the components fold away is optimally adapted to the respective space. The variants pictured on the right show just a few examples of possible „parking“ solutions.

The individual components have a magnetic strip at the connection points, which secures the components together thanks to a 70 N/m tightening force, via a positive-fitting and friction-locked connection.

3| The wall connecting strip serves to receive the first wall element: it is either recessed into the wall or coated with the same surface as the wall.

4| The telescopic element, with its inner extendable telescopic section in the component's surface, provides optimal contact pressure on the wall pressure strip.

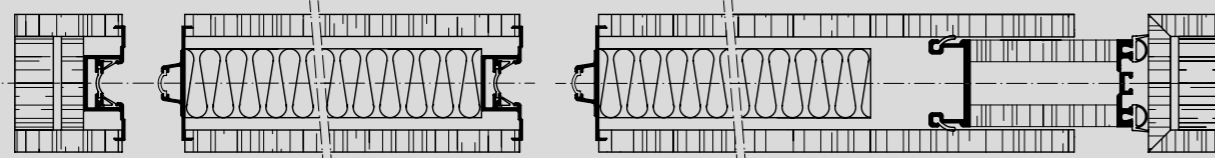

KA-Profil

3

5

4

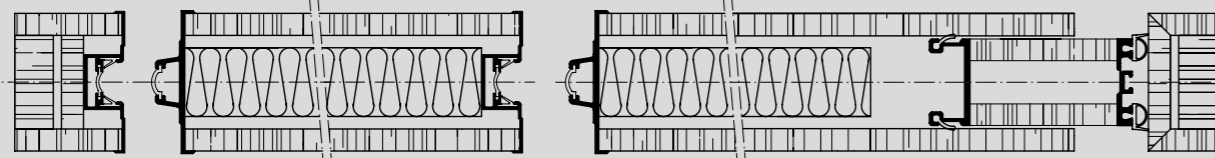

UM-Profil

5| The vertical component edges may be optionally veneered according to the surface, so that even the resulting 4 mm joint between the elements displays no aluminium moulding, or is protected by an 8 mm thick aluminium enclosure moulding.

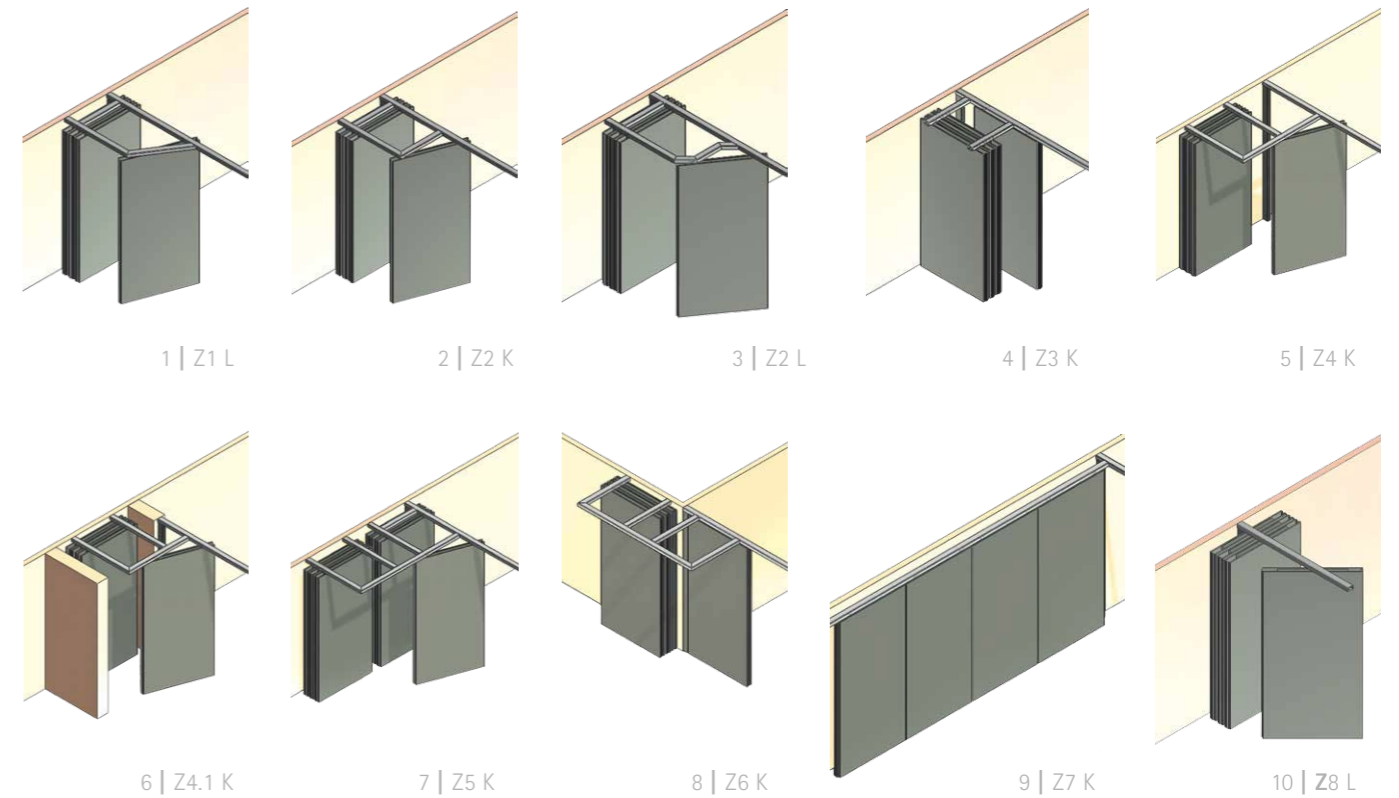

1 | Z1 L

2 | Z2 K

3 | Z2 L

4 | Z3 K

5 | Z4 K

6 | Z4.1 K

7 | Z5 K

8 | Z6 K

9 | Z7 K

10 | Z8 L

The Nüsing partition wall makes any space separation an experience.

We adapt the mounting of the wall component completely to your needs and objectives, in terms of positioning and integration of the wall in the relevant scenario. The surface design of all visible components will follow a consistent design specification, so that the wall assumes a completely natural place in the spatial context. Finding the optimal place for „parking“ is simply a matter of analysing the available space, and provides an opportunity to help shape the style of a room. The result is always unique in its effect – as well as in its quality.

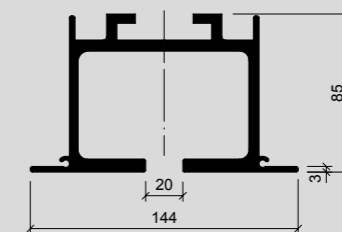
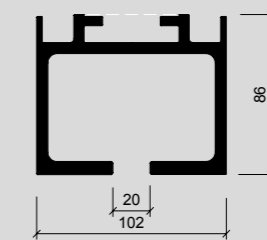

Guide rail: aluminium, with or without ceiling support bracket



Aluminium pressure beam + aluminium tongue + groove profile

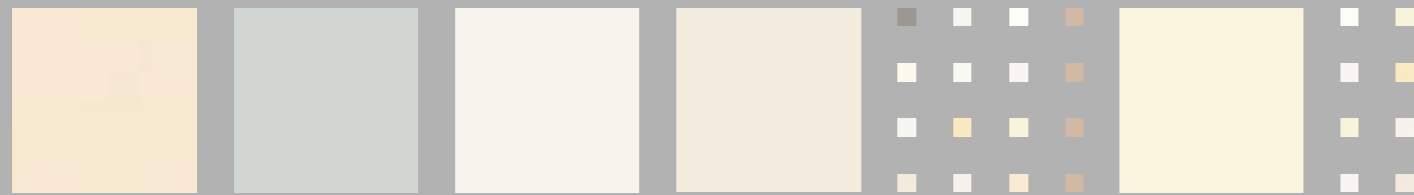

A 320 parchment RAL 1015 Light ivory
 A 402 parchment RAL 7035 Light grey
 A 242 parchment RAL 9010 Pure white or RAL 9003 Signal white
 A 227 parchment RAL 9001 Cream
 A 923 parchment RAL 1013 Oyster white

The surfaces shown in the brochure cannot be portrayed as they are in reality, due to the limitation of the printing process. The full decor experience can be viewed at www.nuesing.com/westag.

All colours are only approximate and samples should be tested in advance. We reserve the right to change the availability and the technology used.

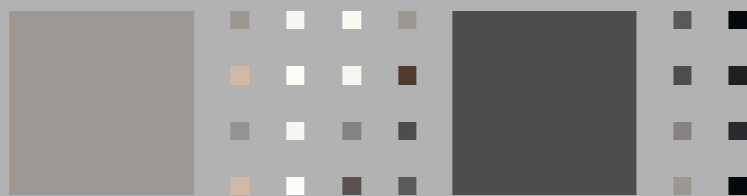

A 444 parchment RAL 7004 Signal grey
 A 411 parchment RAL 7015 Slate grey



P 699 Colin RAL 3031 Orient red
 A 883 parchment RAL 5007 Brilliant blue
 A 506 parchment RAL 6011 Reseda green
 A 920 parchment Canary yellow

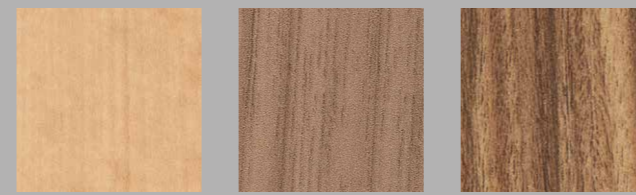

BU 36 Pore F Natural beech
 NU 736 Pore F Walnut Noce Prosecco
 NU 795 Pore F Wild walnut

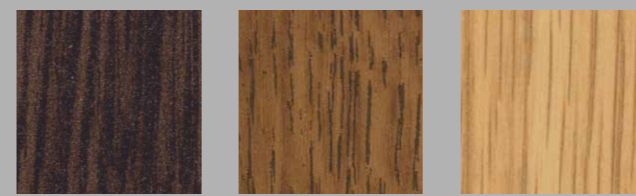
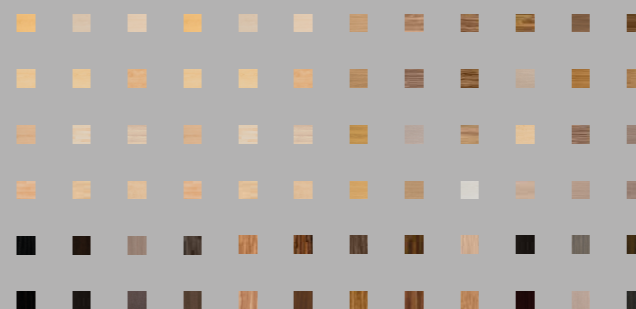

WE 716 Pore F Wengé
 EB 730 Pore D Oak plank, centre mirror
 EIB 310 Pore F Classic oak



Not all surfaces are equal.

The surface design of a partition wall is at least as important as its functionality when it comes to creating the perfect solution for integrated spatial scenarios. A harmonious overall image comes only through the coordinated interaction of all variables. The complete subordination of the surface design to the prevailing colour scheme is just one conceivable variant. The partition wall might likewise become a defining component in terms of colour themes, and imagination knows no boundaries in this respect. The size of the individual panels can be customised – from 1.30 m x 4.10 m to 1.30 m x 2.60 m, depending on the model, thus creating a unique mosaic.

In this way, for example, doors or other functional segments can be colour-highlighted and thus emphasised. The interior-design highlights can thus become distinctive and style-forming elements of the building's design – an effect which can be as a real architectural focal point, thanks to the mobile nature of the internal components. The implementation options are as numerous as your ideas.

Our team stands for reliability and good quality.





Franz Nüsing GmbH & Co. KG
Borkstraße 5
48163 Münster, Germany
Telefon 0251 780010
Fax 0251 780018927
E-Mail info@nuesing.com
www.nuesing.com